

HYBRIX CABINET

Installed on an Axeos unit or can be attached to the wall



VIDEOCONFERENCING

Installation : on an Axeos unit
or attached to the wall

Finish : white and wood

Part numbers :
HYBRIX
HYBRIX_WALL



On an Axeos unit



Attached to the wall

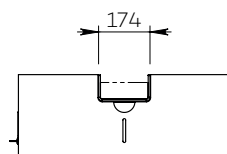
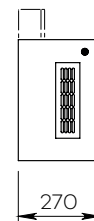
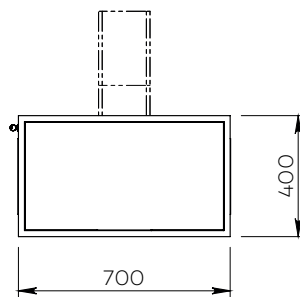

HYBRIX CABINET

• SPECIFICATIONS

Installation	On an Axeos unit	Attached to the wall
Part number	HYBRIX	HYBRIX_WALL
Material	Wooden set White and wood finish	
Access	Push-pull door Key-operated	
Weight	16 kg	
Axeos unit compatibility	Ekinox, Xenon-S, Osyx and Boxer	-
Included	<ul style="list-style-type: none">Internal technology holder	<ul style="list-style-type: none">Internal technology holderWall duct for cables with a 35 mm to 345 mm stroke

• OPTIONS

Front trapdoor customisation Wooden front trapdoor, customised finish on request	P/N: on request
Other finish	P/N: on request